

Jabra Pro 9450 Mono Flex

How to connect my Jabra Pro 9450 with Alcatel Touch 4029, 4039

Prerequisite:

Jabra Pro 9450 + Jabra Link 14201-36

In combination with one of the following phones:

- Touch 4029
- Touch 4039

Connection:

2-sided end:

Insert the RJ45 plug (red banderole) into the red socket marked with "AUX" and the RJ10 plug (blue banderole) into the blue socket identified with the "phone" symbol on the base of the Jabra Pro 94x0.

2-fold Y-coupling end :

Insert the 3.5 mm phone plug into the "headset" interface and the RJ12 plug into the bell socket on the phone. Now plug the phone lead of the phone directly into the additional socket of the Y cable.

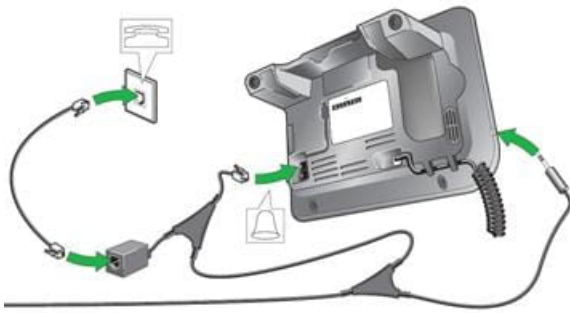

You now have the option of setting up the headset on your phone via the automatic or manual configuration.

Automatic configuration:

To start the automatic configuration, have someone make a call this phone and wait at least 10 seconds before taking the call. The appropriate EHS mode should now be installed.

If the automatic configuration has not worked, please select the MSH mode manually.

Base setup:

Set the phone set-up switch to position "A".

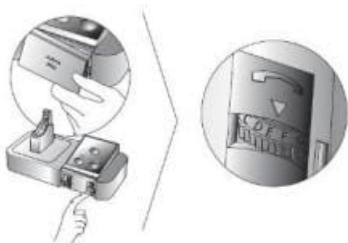

Microphone level setup:

Remove the cover from the base of the Jabra Pro 9450 and make a call

with the headset, to a colleague for example. If you are too loud or too quiet to the person you are calling, please use the volume adjuster until you achieve the optimum volume level.

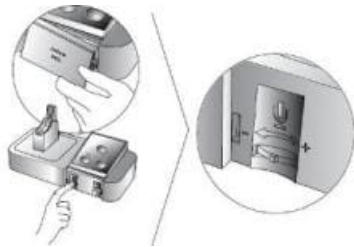

Phone setup with system software version 9.xx and higher:

Settings are no longer required for using the headset on the phone. After correctly adapting the phone plug, a headset symbol must now appear in the “phone display”. Should the headset symbol not appear, please check the following settings:

Menu > Settings > Phone > Phone plug > Activate/select headset.

Phone setup with system software version below 9.xx:

Important: The "Force Headset" function must not be activated on the phone, as otherwise it will not be possible to accept external calls.

Menu > Settings > Phone > Phone plug > Force headset OFF.

Menu > Settings > Phone > Socket > Activate headset.

Dial tone transfer / phone setup:

Important: The dial tone signal in the headset will only transfer when one of the following ring tones has been selected on your phone.

Standard / Classic / Cold River / Dooing-Dooing . > Menu > Settings > Dial tone > Internal / External

In the event that you still do not have a dial tone signal transfer despite setting the correct ring tone, check the following settings:

Menu > Settings > Phone > Internal / External > other options

No tone, progressive, bleep tones > all items must be set to "OFF".

Calls over the headset can be connected/forwarded as follows:

Dial phone number > the following now appears in the phone display
"transfer" > now press the appropriate function button next to the
phone display > when connected you must now end the call using the
button identified with the "handset".